







Engines with the propellor
turning right.
In flight position.

- POLINI THOR 200
- POLINI THOR 250

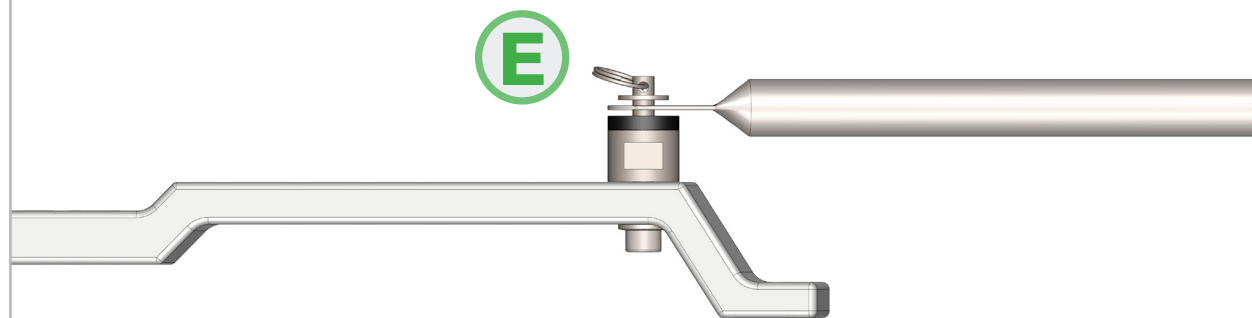

E

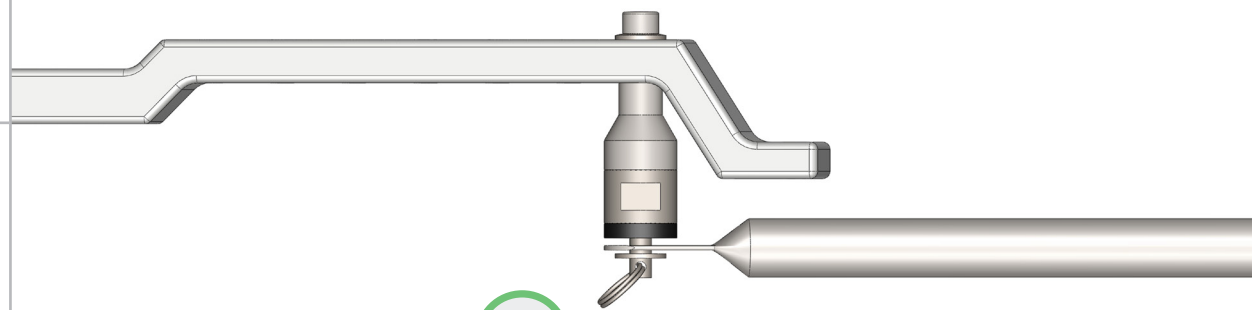

D

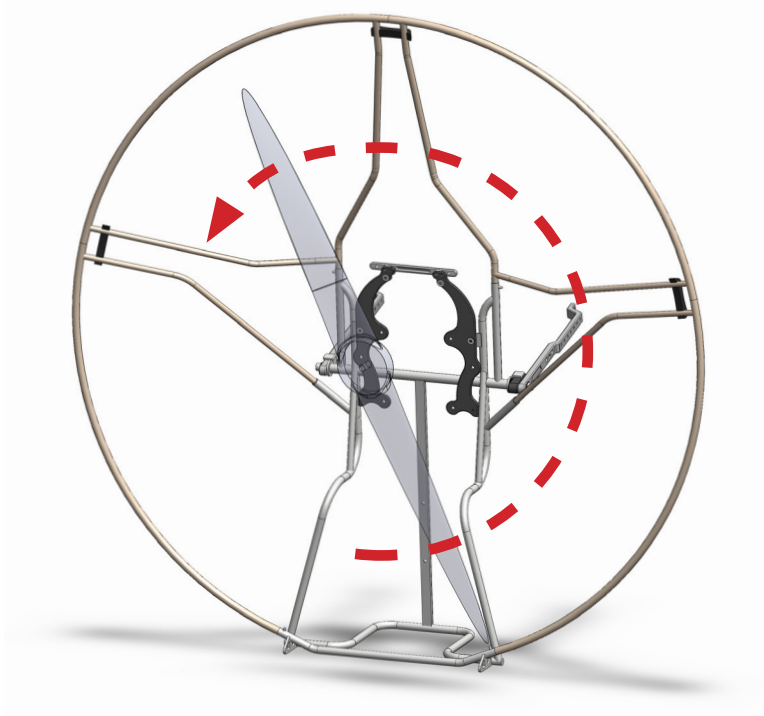

Engines with the propellor
turning left.
In flight position.

· VITTORAZI MOSTER 185

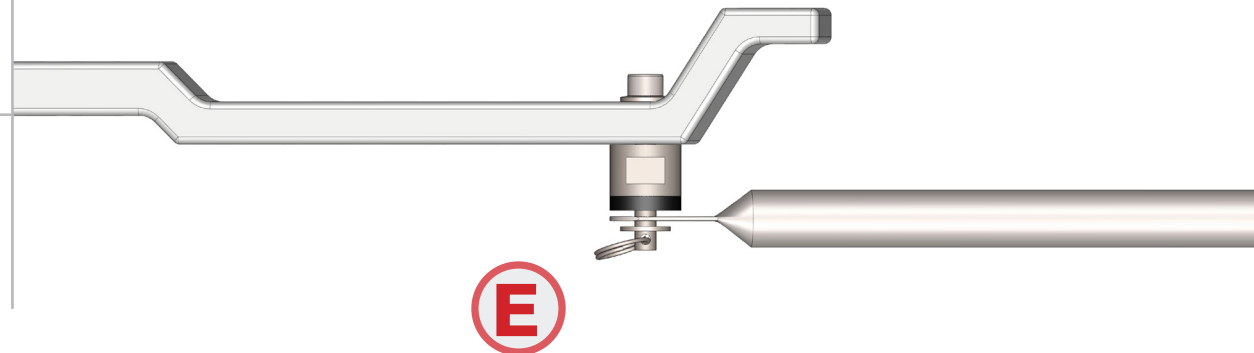
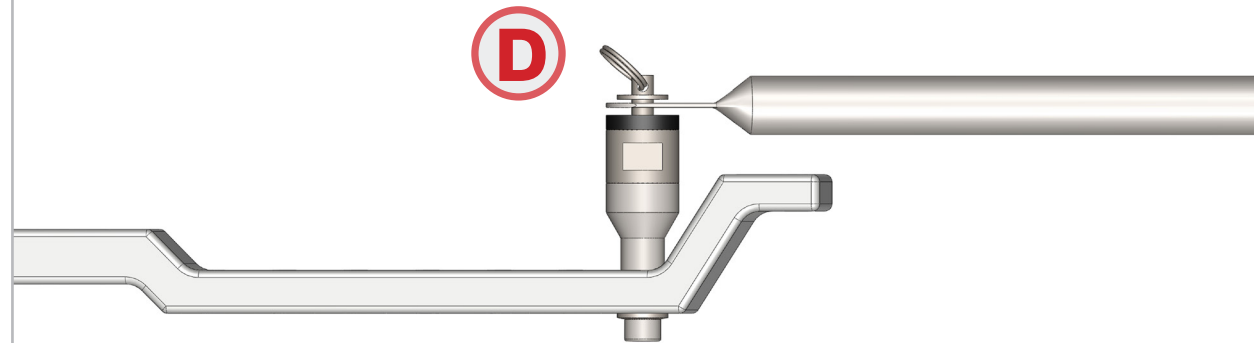

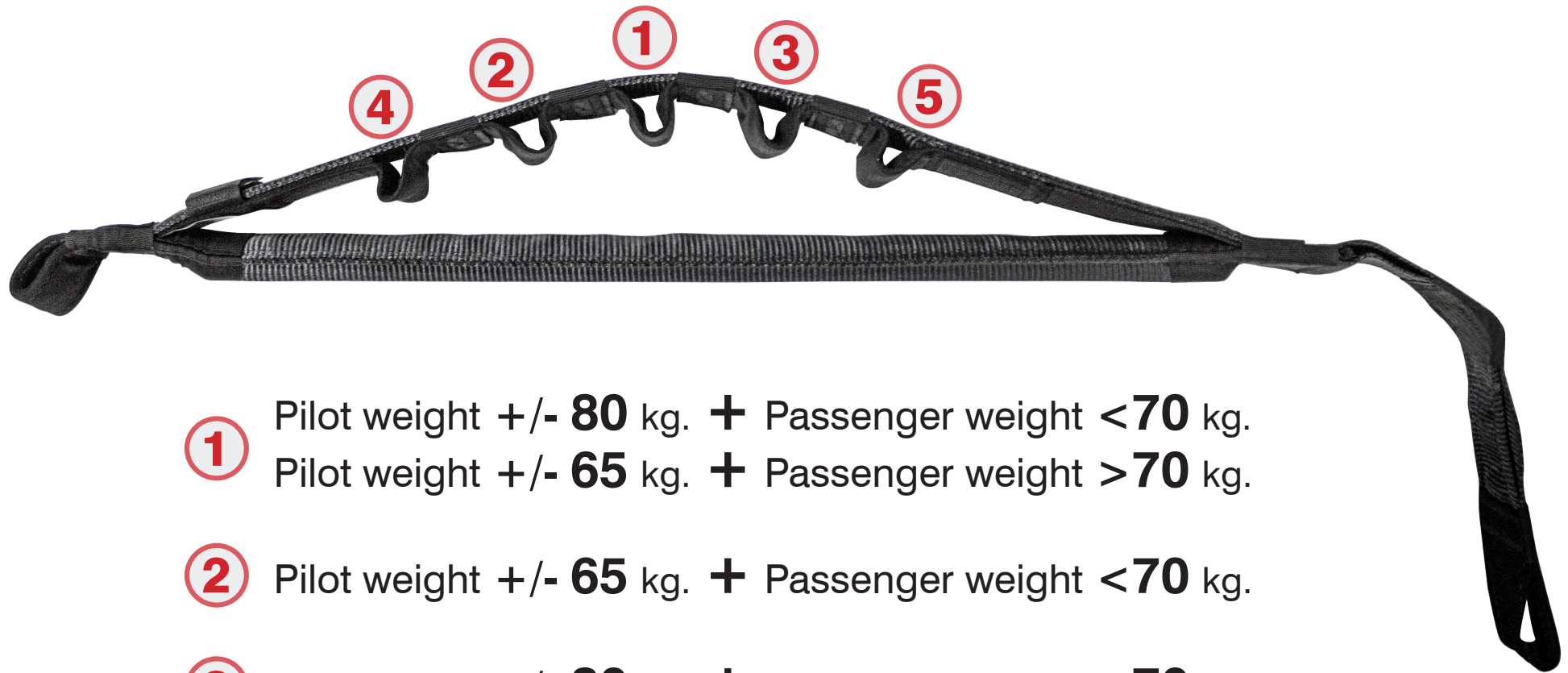

- 1** Pilot weight +/- **80** kg. + Passenger weight <**70** kg.
 Pilot weight +/- **65** kg. + Passenger weight >**70** kg.
- 2** Pilot weight +/- **65** kg. + Passenger weight <**70** kg.
- 3** Pilot weight +/- **80** kg. + Passenger weight >**70** kg.
- 4** Attachment Tandem Parachute
- 5** Pilot weight >**90** kg. + Passenger weight >**80** kg.